

de	Montageanleitung	Stellantriebe
en	Mounting instructions	Actuators
fr	Instructions de montage	Servomoteur
sv	Monteringsinstruktion	Ställdon
nl	Montage-handleiding	Servomotoren
it	Istruzioni di montaggio	Servocomandi
fi	Asennusohje	Toimimoottorit
es	Instrucciones de montaje	Actuadores
da	Monteringsvejledning	Motorer
pl	Instrukcja montażu	Siłowniki
cz	Montážní návod	Pohony
hu	Szerelési útmutató	Motorok
el	Οδηγίες εγκατάστασης	Κινητήρες
zh	安裝指導	執行器

SSA/SSB/SSP31...
SSA/SSB/SSP81...
SSA/SSB/SSP61...

SSA...

SSB...

SSP...

1

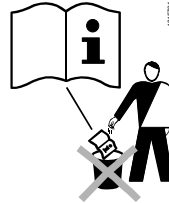

2

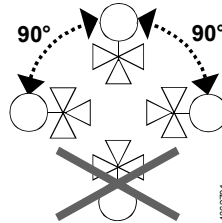

3

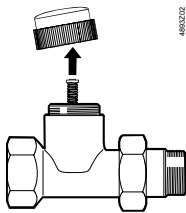

Siemens: VD..., VE..., VU...,
VPD..., VPE..., 2T.../A
Honeywell, MNG, Cazzaniga, Heimeier,
TA (TBV-C), Oventrop

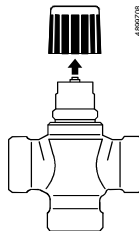

VVP45...¹⁾
VXP45...¹⁾
VMP45...
¹⁾ $k_{VS} \leq 6.3 \text{ m}^3/\text{h}$

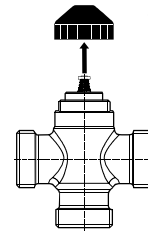

VVP47...
VXP47...
VMP47...

4

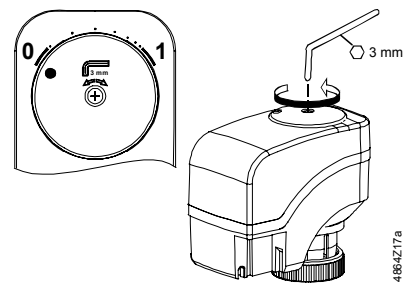
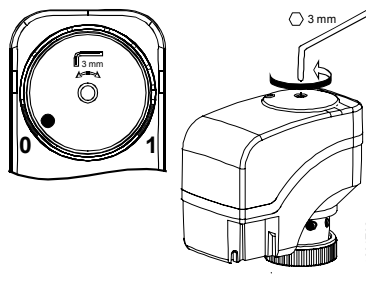
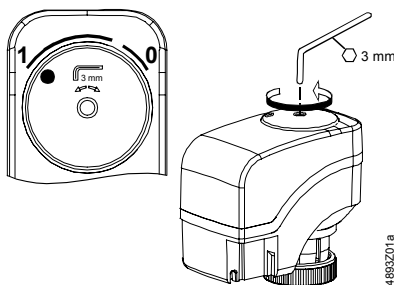

SSA...

SSB...

SSP...

5

AV...

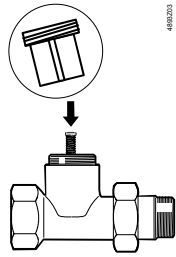

- AV51 Beulco
- AV52 Comap
- AV53 Danfoss RA-N (RA2000)
- AV54 Danfoss RAVL
- AV55 Danfoss RAV
- AV56 Giacomini
- AV57 Herz
- AV58 Oventrop M30x1.0
- AV59 Vaillant
- AV60 TA (TAVC)
- AV61 Markaryd

AL100

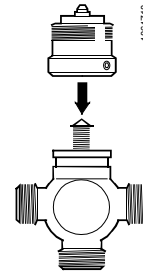

- 2W...
- 3W...
- 4W...

6

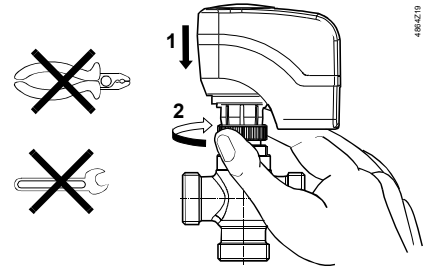
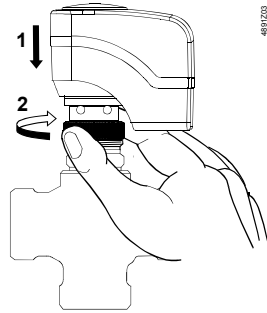
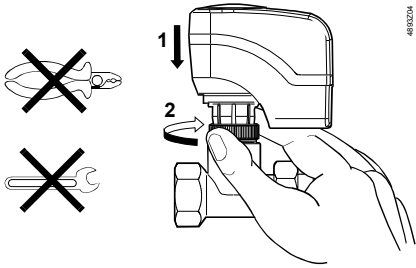

7

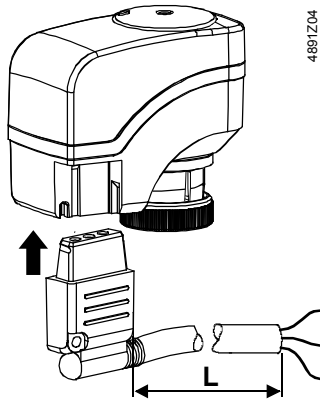

ASY3L...

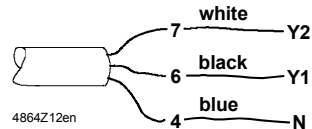

ASY8L...

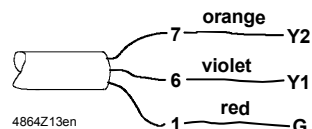

ASY6L...

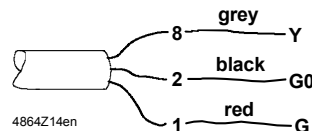

ASY...	L [m]	SSA...	SSB...	SSP...	Y1, Y2, Y
ASY3L15	1.5	SSA31, SSA31.1	SSB31, SSB31.1	SSP31	AC 230 V
ASY3L25	2.5	SSA31/00	SSB31/00	SSP31/00	3-P
ASY3L45	4.5				
ASY8L15	1.5	SSA81, SSA81.1	SSB81, SSB81.1	SSP81, SSP81.04	AC 24 V
ASY8L25	2.5	SSA81/00	SSB81/00	SSP81/00, SSP81.04/00	3-P
ASY8L45	4.5				
ASY6L15	1.5	SSA61	SSB61	SSP61, SSP61P	AC/DC 24 V
ASY6L25	2.5	SSA61/00	SSB61/00	SSP61/00	DC 0...10 V
ASY6L45	4.5				

8

ASY98

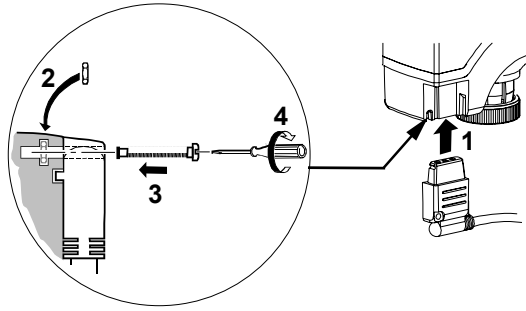

9

ASY99, ASY100

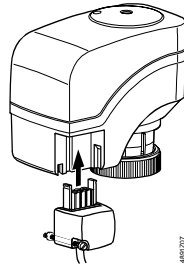
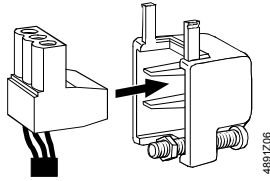

ASY99 → SSA81/00
SSB81/00
SSP81/00
SSP81.04/00



ASY100 → SSA61/00
SSB61/00
SSP61/00



10

- Hubkalibration
- Stroke calibration
- Calibrage de la course
- Lyfthöjdskalibrering
- Slagcalibratie
- Calibrazione corsa
- Iskunpituuden kalibrointi
- Calibración de la carrera
- Slaglængdekalibrering
- Kalibracija skoku
- Kalibrace zdvihu
- Löketbeállítás
- Διαμόρφωση διαδρομής εμβόλου
- 行程校准

SSA61..., SSB61..., SSP61... :

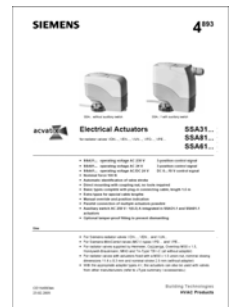
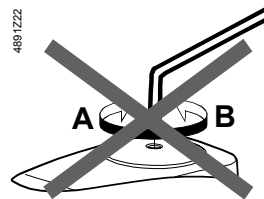

SSA... N4893
SSB... N4891
SSP... N4864

11

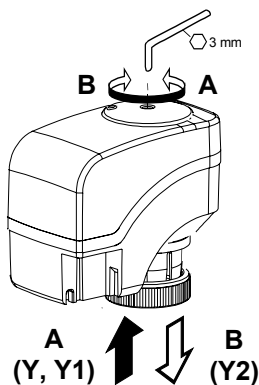
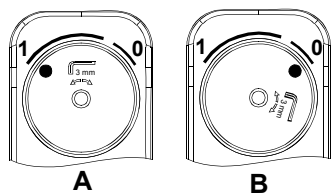

4893Z17

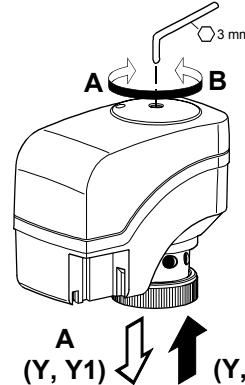
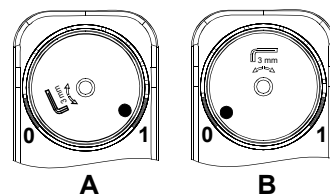

4891Z25

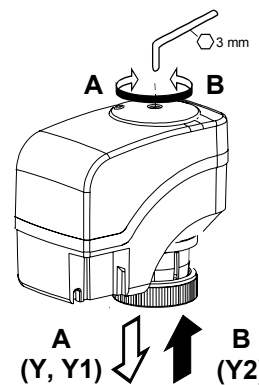
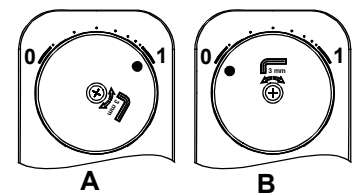

4864Z25

12

SSA31.1, SSA81.1

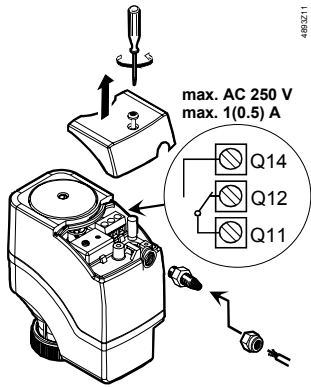

SSB31.1, SSB81.1

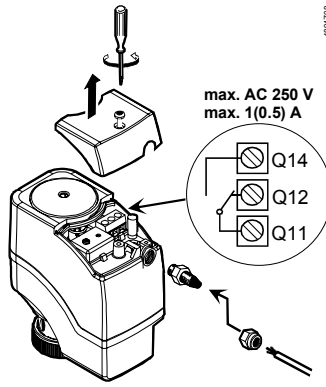

13

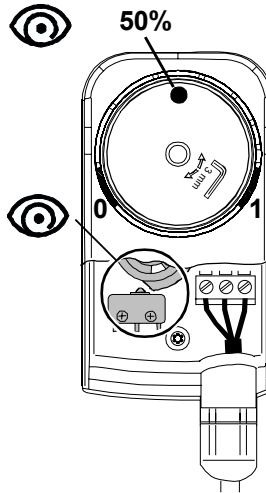
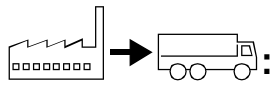
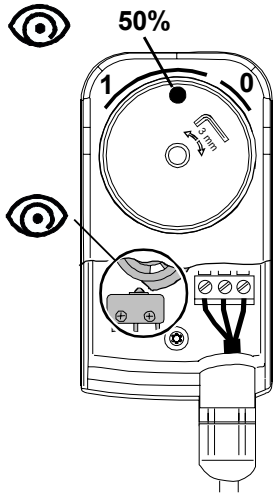
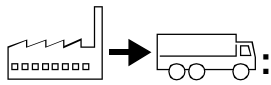

14

0...50%

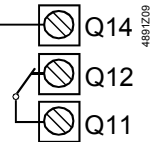

0... < 50%

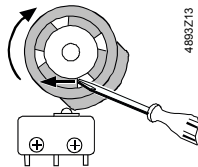

50%...1

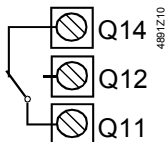

0... > 50%

